

# Gates Chili Middle School

*Together we teach and inspire excellence for all learners.*



## Family Handbook 2023-2024

Gates Chili Middle School  
2 Spartan Way  
Rochester, NY 14624

Main Office: 585.247.5053    Health Office: 585.247.6780

Fax: 585.340.5532

District Switchboard: 585.247.5050    Transportation: 585.247.4774

Principal: Lisa C. Buckshaw, Ed.D.

# The Spartan Way...

## Every Day



Our **District** and **School** community are committed to demonstrating...

**RESPECT**  
**RESPONSIBILITY**  
**COMPASSION**  
**HARD WORK**

The Spartan Way is accomplished by developing Relationships, Rigor, and Relevance.

# TABLE OF CONTENTS

A Welcome from Dr. Lisa C. Buckshaw, Principal	1
School Calendar, 2023-2024	2
GCMS Philosophy	3
Learning Communities	4
GCMS Contact Information	5
Community Contact Information and Daily Schedule	6-8
Exploratory and Additional Staff	9
How to Stay Connected with the Middle School	10-11
First Days of School	12
Day A - D Calendar	13
Supply Lists, 2023-2024	14-15
Honors and Assessment	16
Student Attendance	17
Making up Work/Drop-off/Pick-up Location	18
Activity Period/After School	19
Instructional Technology	19
Progress Reports and Report Cards	20
Code of Conduct and Character	21-22
Upstander Movement	23
Gates Chili Middle School Behavior Matrix	24
School Safety and Emergency Procedures	25-26
Health Office and Counseling	27
School Nutrition Program	28
Parent Teacher Organization and Volunteer Opportunities	29
Extracurricular/Enrichment Opportunities	20-32
Athletics	32
STEP / MCC Program	33
Non-Discrimination Policy	34
Middle School Map	35
Board of Education, 2023-2024	36

# A Welcome From Dr. Buckshaw, Principal

Summer 2023

Dear Gates Chili Middle School Families,

Welcome to the start of a new school year! This *Family Handbook* is a resource for you to reference throughout the school year.

The Gates Chili Middle School (GCMS) community has created an atmosphere where **we teach and inspire excellence for all learners**. This atmosphere flourishes because of the dedicated and accomplished staff, thoughtful and involved families, and positive and responsible students. It takes a commitment from all stakeholders to help reinforce the District core values of respect, responsibility, compassion, and hard work.

As in prior years, Middle and High School students will be provided a District issued laptop to use both at school and at home to extend their learning opportunities. Most of our students kept their devices over the summer. If you did not or you are new to the District, one will be provided to you. The laptops connect our students to rich resources, creative tools, expert access, and authentic audiences available through the Internet. We want students to experience, connect, and interact with the world in ways that traditional textbooks and curriculum alone cannot provide.

The Middle School will be open for families and students to set up lockers and walk a child's schedule at the end of August. On these same days, laptops can be picked up in the High School Field House by students who do not already have one issued.

August 28, 2023                      1:00 pm – 4:00 pm

August 31, 2023                      3:00 pm – 7:00 pm

**Middle School students new to the District as well as 6<sup>th</sup> grade students, transitioning to the building, will have an opportunity to orient themselves in a less crowded atmosphere, on August 28, 2023 at 11:00 AM.**

There are many ways to stay in contact with our school. Consider some of the forums below:

- Check out the middle school website accessed through the district's website: [www.gateschili.org](http://www.gateschili.org)
- Families with an active e-mail address in Schooltool will receive the daily electronic GCMS school newsletter titled, *The Spartan Happenings*.
- Schooltool Parent Portal allows you access to your student's grades, schedule, discipline history, class assignments, etc. If you do not already have an account, once the school year starts an e-mail will be sent with directions and a link to set one up.
- Sign up as a viewer of the following GCMS social media accounts:
  - Twitter account: <https://twitter.com/gateschilims> (@gateschilims)
  - Facebook page: [https://www.facebook.com/pages/Gates-Chili-Middle-School/1494987080783158?ref=aymt\\_homepage\\_panel](https://www.facebook.com/pages/Gates-Chili-Middle-School/1494987080783158?ref=aymt_homepage_panel) (@gateschilims)
  - Instagram account: <https://instagram.com/gateschilims> (@gateschilims)

If you have any questions, please feel free to contact me by calling the main office at 585.247.5050 or e-mailing me at [lisa\\_buckshaw@gateschili.org](mailto:lisa_buckshaw@gateschili.org). I look forward to a wonderful year with you and your student(s).

Sincerely,

Dr. Lisa C. Buckshaw



# School Calendar, 2023-2024

## Gates Chili Central School District • 2023-24 • At-a-Glance District Calendar

KEY

	First Day of School for Students (Gr. P-12)
	No School for Students (Gr. P-12), All Staff Report
	No School for Students (Gr. P-12) and All Staff
	No School for Students (Gr. P-12) and 10-Month Staff
	No School for Students (Gr. P-5)
	No School for Students (Gr. 6-12)
	Half Day for Students (Gr. P-5)
	Half Day for Students (Gr. 6-12)
	Half Day for Students (Gr. P-12)
	NYS Gr. 3-8 Assessments
	NYS Regents Exams

### JULY 2023

July 4 (Tues)..... Independence Day

### AUGUST 2023

Aug. 29-30 (Tues-Wed)..... Superintendent's Conf. Days

### SEPTEMBER 2023

Sept. 4 (Mon)..... Labor Day

Sept. 5 (Tues)..... First Day of School for Students

### OCTOBER 2023

Oct. 6 (Fri)..... Superintendent's Conf. Day

Oct. 9 (Mon)..... Columbus Day/Indigenous People's Day

### NOVEMBER 2023

Nov. 10 (Fri)..... Veterans Day (Observed)

Nov. 22-24 (Wed-Fri)..... Thanksgiving Recess

### DECEMBER 2023

Dec. 4 (Mon)..... P-5 Parent Teacher Conf. / Conf. Day

Dec. 21 (Thur)..... P-5 Parent Teacher Conf. / Conf. Day

Dec. 22-29 (Fri-Fri)..... Holiday Recess

Dec. 25 (Mon)..... Christmas

### JANUARY 2024

Jan. 1 (Mon)..... New Years Day

Jan. 15 (Mon)..... Martin Luther King, Jr. Day

Jan. 23-26 (Tues-Fri)..... NYS Regents Exams

Jan. 26 (Fri)..... Conf. Day

### FEBRUARY 2024

Feb. 19 (Mon)..... President's Day

Feb. 19-23 (Mon-Fri)..... Mid-winter Recess

### MARCH 2024

March 8 (Fri)..... Superintendent's Conf. Day

March 29 (Fri)..... Spring Recess

### APRIL 2024

April 1-8 (Mon-Mon)..... Spring Recess

April 10-17 (Wed-Wed)..... 3-8 ELA Assessment Window

### MAY 2024

May 7-14 (Tues-Tues)..... 3-8 Math Assessment Window

May 24-27 (Fri-Mon)..... Memorial Day Recess

### JUNE 2024

June 4 (Tues)..... NYS Regents Exams

June 14-25 (Fri-Tues)..... NYS Regents Exams

June 19 (Wed)..... Juneteenth

June 20 (Thur)..... Graduation Day

June 25 (Tues)..... Last Day for Students

June 26 (Wed)..... Conf. Day/Last Day for 10-Month Staff

### Required Days in Attendance

Faculty = 187    Students = 181

*\*If there are more than two emergency closing days, it may be necessary to adjust school days in May and/or June.*

*Draft - Jan. 11, 2023 - Not approved*

JULY 2023							AUGUST 2023						
S	M	T	W	T	F	S	S	M	T	W	T	F	S
						1			1	2	3	4	5
2	3	4	5	6	7	8	6	7	8	9	10	11	12
9	10	11	12	13	14	15	13	14	15	16	17	18	19
16	17	18	19	20	21	22	20	21	22	23	24	25	26
23/30	24	25	26	27	28	29	27	28	29	30	31		
SEPTEMBER 2023							OCTOBER 2023						
S	M	T	W	T	F	S	S	M	T	W	T	F	S
					1	2	1	2	3	4	5	6	7
3	4	5	6	7	8	9	8	9	10	11	12	13	14
10	11	12	13	14	15	16	15	16	17	18	19	20	21
17	18	19	20	21	22	23	22	23	24	25	26	27	28
24	25	26	27	28	29	30	29	30	31				
NOVEMBER 2023							DECEMBER 2023						
S	M	T	W	T	F	S	S	M	T	W	T	F	S
			1	2	3	4						1	2
5	6	7	8	9	10	11	3	4	5	6	7	8	9
12	13	14	15	16	17	18	10	11	12	13	14	15	16
19	20	21	22	23	24	25	17	18	19	20	21	22	23
26	27	28	29	30			24/31	25	26	27	28	29	30
JANUARY 2024							FEBRUARY 2024						
S	M	T	W	T	F	S	S	M	T	W	T	F	S
	1	2	3	4	5	6					1	2	3
7	8	9	10	11	12	13	4	5	6	7	8	9	10
14	15	16	17	18	19	20	11	12	13	14	15	16	17
21	22	23	24	25	26	27	18	19	20	21	22	23	24
28	29	30	31				25	26	27	28	29		
MARCH 2024							APRIL 2024						
S	M	T	W	T	F	S	S	M	T	W	T	F	S
					1	2		1	2	3	4	5	6
3	4	5	6	7	8	9	7	8	9	10	11	12	13
10	11	12	13	14	15	16	14	15	16	17			18
17	18	19	20	21	22	23	21	22	23	24	25	26	27
24/31	25	26	27	28	29	30	28	29	30				
MAY 2024							JUNE 2024						
S	M	T	W	T	F	S	S	M	T	W	T	F	S
			1	2	3	4							1
5	6	7	8	9	10	11	2	3	4	5	6	7	8
12	13	14	15	16	17	18	9	10	11	12	13	14	15
19	20	21	22	23	24	25	16	17	18	19	20	21	22
26	27	28	29	30	31		23/30	24	25	26	27	28	29

Together we teach and inspire excellence for all learners.

We will accomplish our mission by building Relationships, Rigor, and Relevance.

We will lead by the four values that define the Spartan Way:

- Respect
- Responsibility
- Compassion
- Hard Work

## Creating a successful learning community...

According to the Association for Middle Level Education, there are 14 characteristics that, when fully implemented, create successful schools for young adolescents.

These characteristics are:

- Educators who value working with this age group and are prepared to do so;
- Courageous, collaborative leadership;
- A shared vision that guides decisions;
- An inviting, supportive, and safe environment;
- High expectations for every member of the learning community;
- Students and teachers engaged in active learning;
- An adult advocate for every student;
- School-initiated family and community partnerships;
- Curriculum that is relevant, challenging, integrative, and exploratory;
- Multiple learning and teaching approaches that respond to their diversity;
- Assessment and evaluation programs that promote quality learning;
- Organizational structures that support meaningful relationships and learning;
- School-wide efforts and policies that foster health, wellness, and safety;
- Multifaceted guidance and support services.

We embrace these characteristics; *therefore*, we proudly dedicate ourselves to being the best middle school level educators we can be.

# Learning Communities

Gates Chili Middle School is divided into three 6th - 8th grade communities of learning: Amerks, Redwings, and Rhinos. For the most part, students remain in the same community throughout their middle school experience, resulting in a sustained relationship with the teachers who serve them. Parents also find it easier to talk to a common core of staff members.

Communities provide for the following:

- greater sense of belonging (closer relationships with teachers, who in turn, have a better understanding of their students' unique learning needs and interests)
- added convenience for students with many classes close to one another in a specific wing of the school
- reduction of student movement throughout the building, thereby creating additional time for instruction; increased number of interactions between your child and his/her teachers and peers within a community, while helping to reduce disciplinary issues.

Since these communities comprise one much larger school, GCMS students enjoy the best of both worlds, with school-wide theme weeks, clubs, socials, performing groups and athletic teams. GCMS students are mixed in several of their exploratory classes to enable new friendships and rekindle old ones with students who are assigned to any one of our separate communities. Providing optimal learning environments has been an essential goal of the school district. The creation of Middle School communities has helped us to take a significant step forward to this end.

## **HOW ARE WE ACHIEVING OUR VISION?**

- Three communities spanning grades six through eight are in operation.
- We try to have students remain in the same community for the duration of their time at Gates Chili Middle School; However, this does not always happen.
- Communities are housed in separate wings of the building.
- Each community is assigned its own administrator and teams of English, math, science, and social studies teachers whose rooms are housed together in a common hallway.
- The location of the cafeteria, library, art, Family and Consumer Science (FACS), technology, and music wings remain common to all students.



# GCMS Contact Information

<b>CONTACT INFORMATION</b> <b>SCHOOL PHONE NUMBER:</b> 585.247.5053 <b>BUILDING PRINCIPAL:</b> Dr. Lisa Buckshaw <b>Secretary:</b> Ms. Mercedes Burdick <b>Greeter:</b> Ms. Wendy Valone and Ms. Murphy <b>Counseling Secretary:</b> Ms. Sandra Gladney	
<b><u>AMERKS COMMUNITY</u></b> Administrator: Mrs. Michelle Dossier Secretary: Ms. Linda Saraceni  <b><u>Counselors:</u></b> Ms. Alisha Nelson: Grade 6 Ms. Emily Rice: Grades 7 & 8	<b><u>RHINOS COMMUNITY</u></b> Administrator: Mrs. Zalika Johnson Secretary: Mrs. Mary Pat Steiner  <b><u>Counselor:</u></b> Mrs. Melissa Conditorio: Grades 6 – 8
<b><u>REDWINGS COMMUNITY</u></b> Administrator: Ms. Kenyala Rollins Secretary: Mrs. Christine Newman  <b><u>Counselors:</u></b> Ms. Alisha Nelson: Grade 6 Ms. Kereen Sabido: Grades 7 & 8	<b><u>Health Office</u></b> Nurse: Mrs. Tyna Fowler Health Aide: Ms. Brenda Donovan  <b><u>Attendance Office</u></b> Mrs. Joann Brown
<b><u>School Nutrition Office:</u></b> 585.247.5050 Director of School Nutrition: Janice Phillips  <b><u>Cafeteria:</u></b> Mrs. Sue Schleyer, Cafeteria Manager  <b><u>Cafeteria Monitors:</u></b> Ms. McGrath Ms. Jessie Legette Ms. Christina Hefner  <b><u>Reading Office:</u></b> Mrs. Janet Martinek, Building Reading Teacher Ms. Gina Pecora, Reading Aide	<b><u>Custodial Staff:</u></b> Mr. Todd Carr, Head Custodian Mr. Michael Prystajko, Custodian Mr. Michael Pipkin, Custodian  <b><u>Microcomputer Maintenance Technician:</u></b> Ms. Jordan Zavery (Zusy)  <b><u>Library:</u></b> Ms. Cynthia Ratajczak, Library Media Specialist Ms. Lisa Preble, Library Aide



# Community Contact Information and Daily Schedule

**AMERK COMMUNITY**  
**Administrator—Mrs. Michelle Dossier**  
**Secretary—Ms. Linda Saraceni**



<b>GRADE 6</b>	<b>SPECIAL EDUCATION 8:1+1</b>
Mrs. Meyer (Math)	Ms. Fox (Grades 6, 7, 8)
Mrs. Muscarella (Science)	
Mrs. Beh (ELA)	
Ms. Kanaley (Social Studies)	
Mr. LeClair (Reading)	<b>ESOL</b>
SE Consult: Ms. Houser, TBD	Ms. Zisis
Counselor: Mrs. Nelson	
Psychologist: Mrs. Carroll	
Social worker: Ms. Gorski	
<b>GRADE 7</b>	<b>GRADE 8</b>
Mr. Phillips (Math)	Mr. Gillett (Math)
Mr. Drew (Science)	Mr. Caboot (Science)
Mrs. Fredericks (English)	Ms. Hill (English)
Mr. A. LeClair (Social Studies)	Mrs. Hammel (Social Studies)
SE Consult: Mr. Miller, Mrs. Mitchell	SE Consult: Mr. Baker, Ms. Soprano
Counselor: Mrs. Rice	Counselor: Mrs. Rice
Psychologist: Mrs. Yates	Psychologist: Mrs. Salton
Social worker: Ms. Gorski	Social worker: Ms. Gorski

**REDWING COMMUNITY**  
**Administrator—Ms. Rollins**  
**Secretary—Ms. Christine Newman**

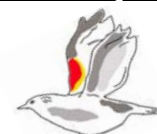

<b>GRADE 6</b>	<b>GRADE 7</b>
Mrs. Sica (Math)	Mr. Chase (Math)
Mrs. Brenneis (Science)	Dr. Williamson (Science)
Mrs. Dorofy (ELA)	Mrs. Winter (English)
Mrs. Sheridan (Social Studies)	Mrs. Veneziano-Pulliam (Social Studies)
Mrs. Salgado-Givens (Reading)	SE Consult: Ms. Hackett
SE Consult: Mr. Donleavy, Mrs. Walsh	Counselor: Ms. Sabido
Counselor: Ms. Nelson	Psychologist: Mrs. Yates
Psychologist: Mrs. Carroll	Social worker: Mrs. McKenzie
Social worker: Mrs. McKenzie	
<b>GRADE 8</b>	<b>CaSSP</b>
Mrs. Radley (Math)	Ms. McGarrigle
Mr. Dennis (Science)	Mr. Valerio
Mrs. Carr (English)	
Ms. LaMorte/Mr. Valerio (Social Studies)	<b>SPECIAL EDUCATION 15:1+1</b>
SE Consult: Mrs. Pratt	Mrs. Tillson, Ms. Leonard
Counselor: Ms. Sabido	
Psychologist: Mrs. Salton	
Social worker: Mrs. McKenzie	

# Community Contact Information and Daily Schedule

## RHINO COMMUNITY Administrator—Ms. Zalika Gomes Secretary—Mrs. Mary Pat Steiner



GRADE 6	ESOL
Mrs. Rappleye (Math/Science/Reading)	Mrs. Whitford
Mrs. Cleveland (ELA/Social Studies/Reading)	Ms. Taylor-Velez
Counselor: Mrs. Condidorio	
Psychologist: Mrs. Carroll	
Social worker: Mrs. Sprague	<b>SPECIAL EDUCATION</b>
	<b>12:1+1</b>
<b>GRADE 7/8</b>	Mrs. Julian
Mrs. Stehler (Math)	
Mrs. Mantsi (Science)	
Mrs. Coughlin (English)	
Mrs. Spoto (Social Studies)	<b>6:1+1</b>
Counselor: Mrs. Condidorio	Mrs. Marciano
Psychologist: Mrs. Yates Grade 7 / Mrs. Salton Grade 8	
Social worker: Mrs. Sprague	



# Community Contact Information and Daily Schedule

---

**Rhino Schedule 2023-2024**

<b>Class Period</b>	<b>Time</b>
Period 1	7:58-8:48
Period 2	8:52-9:35
Period 3RH	9:39-10:22
Rhino Lunch	10:26-11:01
Period 4RH	11:05-11:48
Period 5	11:52-12:35
Period 6	12:39-1:22
Period 7	1:26-2:09
Period 8	2:13-2:57

**Red Wing Schedule 2023-2024**

<b>Class Period</b>	<b>Time</b>
Period 1	7:58-8:48
Period 2	8:52-9:35
Period 3	9:39-10:22
Period 4	10:26-11:09
RW Lunch	11:13-11:48
Period 5	11:52-12:35
Period 6	12:39-1:22
Period 7	1:26-2:09
Period 8	2:13-2:57

**Amerk Schedule 2023-2024**

<b>Class Period</b>	<b>Time</b>
Period 1	7:58-8:48
Period 2	8:52-9:35
Period 3	9:39-10:22
Period 4	10:26-11:09
Period 5AM	11:13-11:56
Amerk Lunch	12:00-12:35
Period 6AM	12:39-1:22
Period 7	1:26-2:09
Period 8	2:13-2:57

# Exploratory Teachers & Additional Staff

<b>Art</b> Mrs. Cocuzzi Mrs. Manou	<b>Library</b> Ms. Ratajczak
<b>Music</b> Ms. Bailey Mr. Carbary Mrs. Ciarvella Ms. DeGrave Ms. Moshier	<b>World Language (WL)</b> Mrs. Falletti Mrs. Gelfuso Mrs. Sousanna-Bann Mrs. Patrei Mrs. Quagliatta TBD
<b>Physical Education</b> Mrs. Bartula Mr. Candileri Mr. Johnson Mrs. Riggi	<b>Technology</b> Mr. Handley Mr. Maznikovski TBD
<b>Speech</b> Mrs. Andrews-Smith Mrs. Austin	<b>Health</b> Ms. Henchen Mrs. Strong Ms. Acevedo
<b>Family and Consumer Science</b> Ms. Blaes Mrs. Navarro-Lindsay	<b>In-School Suspension Teaching Assistant</b> Ms. Freitag  <b>In-School Suspension Teacher Aide</b> Mr. Capostagno  <b>Out-of-School Suspension Teacher</b> TBD
<b>Academic Intervention Service – Literacy</b> Mrs. Carpenter Mrs. Martinek Mrs. Paiement Mrs. Ruckdeschel Ms. Davenport	<b>Academic Intervention Service – Math</b> Ms. Ferrari Mr. Manzer Mrs. Rahmlow Mr. Bergersen





# How to Stay Connected with the Middle School

## 1. Parent Portal

Available to Gates Chili Middle School families is a tool called the Parent Portal. Using a password protected program, you are afforded the opportunity to view your student's schedule, grades, discipline history, attendance, etc. Once school begins, the student's primary contact will be sent an e-mail with a code to the portal. Parent Portal provides access to your student's schedule, five-week progress reports, and quarterly report cards. For more specific information about how to use Parent Portal, please go to <https://www.gateschili.org/Domain/505>.

Taking advantage of the continuous feedback provided by the portal will allow families the opportunity to converse more explicitly with their student about completed assignments and/or work that may be owed. It will also provide family members an opportunity to celebrate a student's success on individual school assessments and earlier warning if a student is in academic jeopardy.

## 2. Schoology

The Gates Chili Central School District uses Schoology as its learning management system to help guide instruction in an online environment. Students can

- engage in collaborative discussions,
- complete assignments,
- take online assessments,
- and much more!

Guardians are also provided a Schoology account. Providing this access offers the ability to view activity within the platform and follow their student's learning more closely.

For specific sign up directions, please go to

<https://www.gateschili.org/cms/lib/NY02214396/Centricity/Domain/720/Schoology%20Parent%20Access%20Directions.pdf>

To log into Schoology, please go to <https://app.schoology.com/login>

## 3. Phone Calls/e-mail

Utilize phones or e-mail to communicate with your student's teachers or counselor before an issue becomes bigger. We can work together to address the needs of your student. Communication tends to be best understood through face-to-face conference or phone conversation.

## 4. Social Media: Twitter, Facebook, and Instagram

Twitter, Facebook, and Instagram are social media tools to keep our community informed about key Middle School events. Follow the Middle School by going to the middle school website and clicking on the link to the left of the screen or by finding us @gateschilims.

<https://www.gateschili.org/Page/17154>

## 5. Middle School Website: <https://www.gateschili.org/Page/11816>

The website features news items as well as links to Schoology, Twitter, Facebook, Instagram, *Spartan Happenings*, community webpages, PTO, honor roll/high honor roll recognition, *Students of the Month*, school news items, Upstander initiative, *School Improvement Team (SIT)*, clubs and activities, dance expectations, *Code of Conduct and Character*, staff directory, teacher webpages, parent handbook, etc.

## 6. Spartan Happenings

This is a daily electronic newsletter from the Middle School that provides a summary of the morning announcements and important information to families about upcoming events. It is e-mailed daily to parents/guardians with an active e-mail account posted in Schooltool. It can also be accessed on the

# How to Stay Connected with the Middle School

GCMS website. Go to [gateschili.org](https://www.gateschili.org); select the SCHOOLS tab at the top; drop down to Middle School; then select the PARENTS AND STUDENTS tab at the top. Select “Spartan Happenings” from the directory. Announcements are placed in the Spartan Happenings folder at 10:00 a.m. each day. <https://www.gateschili.org/Domain/508>

## 7. Parent/Guardian Conferences

The Middle School does not have designated parent/guardian conference days, but you are always invited to set one up by contacting one of the teachers on your student’s team. These can occur in person or virtually.



# First Day of School & Pattern Calendar

## **When will my child receive a schedule?**

During the summer, in late August, student schedules will be mailed home and will be available in SchoolTool. Students will receive a locker assignment at the same time as their schedule.

## **Transportation**

In late August, information regarding the time of pick-up and the bus number for your student will be mailed to your home from the Transportation Department. If you have questions about your student's bus information, please call the Transportation Department at 585.247.4774.

## **Summer Visitations**

Students, accompanied by a parent or guardian, are welcome to visit the Middle School to set up their lockers and “walk their schedules.” The building will be open during the following times:

August 28, 2023: 1:00 – 4:00 pm

August 31, 2023: 3:00 – 7:00 pm

## **New to District and Incoming 6<sup>th</sup> Grade Students**

Middle School students new to the district as well as 6<sup>th</sup> grade students, entering the building for the first time, will have an opportunity to orient themselves to the building in a less crowded atmosphere, on August 28, 2023, at 11:00 am.

## **Student Laptop Distribution**

The majority of our 5<sup>th</sup> through 7<sup>th</sup> grade students kept their District issued laptops over the summer. If your student does not already have a District issued laptop, it can be picked up at the same time as the summer visitations, at the High School. It is very important that students are accompanied by a parent or guardian and that they complete the appropriate forms online (<https://www.gateschili.org/domain/956>) otherwise, the laptop may not be able to be taken home.

## **First Full Day of School**

The first day of school for **ALL** students is Tuesday, September 5, 2023. All students will report to their A-day period 1 class. This room number can be found on the student's individual schedule. Students who would like to get breakfast will pick it up in the cafeteria upon arrival and then report to their A-day period 1 class.

## **What's for lunch on Opening Day?**

Check the Gates Chili School District website <https://www.gateschili.org/Page/120> for the Monthly Menu and also other important School Nutrition information and updates. The menu for September will be posted in late August.

# First Day of School & Pattern Calendar

## Gates Chili Middle and High School · 2023-24 · Student Pattern Day Calendar

SEPTEMBER 2023					
M	T	W	T	F	
				1	
4	5 A	6 B	7 C	8 D	
11 A	12 B	13 C	14 D	15 A	
18 B	19 C	20 D	21 A	22 B	
25 C	26 D	27 A	28 B	29 C	

OCTOBER 2023					
M	T	W	T	F	
2 D	3 A	4 B	5 C	6 ▲	
9	10 D	11 A	12 B	13 C	
16 D	17 A	18 B	19 C	20 D	
23 A	24 B	25 C	26 D	27 A	
30 B	31 C				

NOVEMBER 2023					
M	T	W	T	F	
		1 D	2 A	3 B	
6 C	7 D	8 A	9 B	10 ●	
13 C	14 D	15 A	16 B	17 C	
20 D	21 A	22	23	24	
27 B	28 C	29 D	30 A		

DECEMBER 2023					
M	T	W	T	F	
				1 B	
4 C	5 D	6 A	7 B	8 C	
11 D	12 A	13 B	14 C	15 ▲ D	
18 A	19 B	20 C	21 D	22	
25	26	27	28	29	

JANUARY 2024					
M	T	W	T	F	
1	2 A	3 B	4 C	5 D	
8 A	9 B	10 C	11 D	12 A	
15	16 B	17 C	18 D	19 A	
22 B	23 C	24 D	25 A	26 ●	
29 B	30 C	31 D			





FEBRUARY 2024					
M	T	W	T	F	
			1 A	2 B	
5 C	6 D	7 A	8 B	9 C	
12 D	13 A	14 B	15 C	16 D	
19	20	21	22	23	
26 A	27 B	28 C	29 D		

MARCH 2024					
M	T	W	T	F	
				1 ▲ A	
4 B	5 C	6 D	7 A	8	
11 B	12 C	13 D	14 A	15 B	
18 C	19 D	20 A	21 B	22 C	
25 D	26 A	27 B	28 C	29	

APRIL 2024					
M	T	W	T	F	
1	2	3	4	5	
8	9 D	10 A	11 B	12 ● C	
15 D	16 A	17 B	18 C	19 D	
22 A	23 B	24 C	25 D	26 A	
29 B	30 C				

MAY 2024					
M	T	W	T	F	
		1 D	2 A	3 B	
6 C	7 D	8 A	9 B	10 C	
13 D	14 A	15 B	16 C	17 ▲ D	
20 A	21 B	22 C	23 D	24	
27	28 A	29 B	30 C	31 D	

JUNE 2024					
M	T	W	T	F	
3 A	4 B	5 C	6 D	7 A	
10 B	11 C	12 D	13 A	14 B	
17 C	18 D	19	20 A	21 B	
24 C	25 ● D	26	27	28	

KEY		No School for Students and Staff
		No School for Students, Staff Reports
		Middle of quarter
		End of quarter

### Marking Periods

Oct. 6 Mid-quarter  
Nov. 10 Quarter 1 end  
Dec. 15 Mid-quarter  
Jan. 26 Quarter 2 end

March 1 Mid-quarter  
April 12 Quarter 3 end  
May 17 Mid-quarter  
June 25 Quarter 4 end

Final- May 19, 2023



# Supply Lists, 2023 - 2024

## Gates Chili Middle School

### 6th Grade Supply List 2023 - 2024



**ALL SUPPLIES WILL BE PURCHASED BY THE DISTRICT EXCEPT FOR THOSE IN THE BOX TITLED, "FAMILY RESPONSIBILITY FOR PURCHASING."**

#### **FAMILY RESPONSIBILITY FOR PURCHASING**

- |   |  |
|---|--|
| <ul style="list-style-type: none"><li>• ear buds/headphones - (required)</li><li>• TI-30XIIS calculator - (required)</li><li>• sneakers and comfortable clothing for PE - (required)</li><li>• Band - woodwind reeds (as needed)</li><li>• Band - brass valve oil (as needed)</li></ul> | <ul style="list-style-type: none"><li>• water bottle- (optional)</li><li>• locker shelf - (optional)</li><li>• inexpensive stylus - (optional)</li><li>• computer mouse - (optional)</li><li>• sketchbook for Art - (optional)</li></ul> |
|---|--|

**GENERAL SUPPLIES: The items below will be purchased by the district except where indicated.**

- pencils
- colored
- blue or black pens
- pencil pouch/box
- ear buds/headphones - (Family Responsibility - required)

**ELA/SS/SCIENCE/READING/MATH: The items below will be purchased by the district except where indicated.**

- one 2-inch binder (It will be used for all five of these classes. You do not need a separate one for each class)
- 5 dividers
- TI-30XIIS calculator - (Family Responsibility - required)

**OTHER COURSES: The items below will be purchased by the district except where indicated.**

#### **PHYSICAL EDUCATION:**

Come to PE with sneakers and comfortable clothing - (Family Responsibility- required)

#### **AIS – LITERACY (as applicable):**

- one 2-pocket folder

#### **AIS – MATH (as applicable):**

- one 2-pocket folder

#### **HEALTH 6:**

- one 2-pocket folder

#### **FAMILY AND CONSUMER SCIENCE (FACS) 6:**

- one 2-pocket folder

#### **ART 6:**

- one 2-pocket folder
- sketchbook - (Family Responsibility- optional)

# Supply Lists, 2023 - 2024

## Gates Chili Middle School

### 7th & 8th Grade Supply List 2023 - 2024



**ALL SUPPLIES WILL BE PURCHASED BY THE DISTRICT EXCEPT FOR THOSE IN THE BOX TITLED, "FAMILY RESPONSIBILITY FOR PURCHASING."**

#### **FAMILY RESPONSIBILITY FOR PURCHASING**

- |   |  |
|---|--|
| <ul style="list-style-type: none"><li>• ear buds/headphones - (required)</li><li>• TI-30XIIS calculator - (required)</li><li>• sneakers and comfortable clothing for PE - (required)</li><li>• Band - woodwind reeds (as needed)</li><li>• Band - brass valve oil (as needed)</li></ul> | <ul style="list-style-type: none"><li>• water bottle- (optional)</li><li>• locker shelf - (optional)</li><li>• inexpensive stylus - (optional)</li><li>• computer mouse - (optional)</li><li>• sketchbook for Art (6th/8th grade) - (optional)</li></ul> |
|---|--|

**GENERAL SUPPLIES:** The items below will be purchased by the district except where indicated.

- pencils
- blue or black pens
- pencil pouch/box
- ear buds/headphones - (Family Responsibility - required)

**ELA/SS/SCIENCE/MATH:** The items below will be purchased by the district except where indicated.

- one 2-inch binder (it will be shared for all four of these classes. You do not need a separate one for each class)
- 5 dividers
- TI-30XIIS calculator - (Family Responsibility - required)

**OTHER COURSES:** The items below will be purchased by the district except where indicated.

#### **SPANISH, ITALIAN, FRENCH**

- 1 1/2" 3 ring- binder
- 5 dividers

#### **LATIN**

- one 3-subject spiral notebook (with pocket inside if possible)

#### **PHYSICAL EDUCATION:**

Come to PE with sneakers and comfortable clothing - (Family Responsibility- required)

#### **AIS – LITERACY (as applicable):**

- one 2-pocket folder

#### **AIS – MATH (as applicable):**

- one 2-pocket folder

#### **HEALTH 7:**

- one 2-pocket folder

#### **FAMILY AND CONSUMER SCIENCE (FACS) 7:**

- one 2-pocket folder

#### **DIGITAL ART 7 (as applicable):**

- folder
- external mouse

#### **TECHNOLOGY 8**

- 2" 3-ring binder
- 4 glue sticks
- 12" ruler with standard and metric

#### **ART 8**

- one 2-pocket folder

# Honors and Assessment

## ACADEMIC HONORS

Gates Chili Middle School has three methods to recognize superior student achievement each quarter: Honor Roll, High Honor Roll, and Reach Roll. The criteria for each are as follows:

- **Honor Roll:** an overall quarterly average between 87.5% and 92.4%
- **High Honor Roll:** an overall quarterly average of 92.5% or higher
- **Reach Roll:** an overall increase in a quarterly average by 5 percentage points or more and no failing quarter grades

## ASSESSMENT

Each year students in Grades 3-8 take the New York State tests in English Language Arts and Mathematics. Students in Grades 5 and 8 also take the New York State Science exam. The New York State testing program is designed to evaluate the implementation of the State's Learning Standards at the student, school, district, and state levels.

Testing plays an important role in education at every level. Data collected from State Assessments, unit tests and quizzes, and daily homework assignments is used by classroom teachers to inform them about their practice and your student's learning needs. Assessment information helps teachers plan their instruction and identify interventions necessary to support a student's academic success. The information gained from your student's participation in State Assessments is not used in isolation to determine program placement. The information is used in combination with classroom performance and teacher recommendation to identify the supports needed to help all students be successful.

Final exams will be administered to measure the academic growth of each student. The final exam scores will be posted on your child's report card and will be weighted 20% of the fourth quarter average.

Below are the **TENTATIVE** New York State Assessments in ELA, Math, and Science 8 as follows:

- Grades 6–8 English Language Arts: April 8 – May 17, 2024 (selected dates during this timeframe)
- Grades 6–8 Mathematics: April 8 – May 17, 2024 (selected dates during this timeframe)
- Grade 8 Science: April 8 – May 17, 2024 (selected dates during this timeframe)
- Algebra I Regents: Tuesday, June 4, 2024
- Regents Earth Science: Thursday, June 20, 2024

---

## **Toolkit for Parents and Families**

NYS has created a *Toolkit for Parents and Families* that is a collection of materials and resources that will help parents and families understand the New York State education reform initiatives and how the changes will help your student graduate from high school ready for college and careers (<https://www.engageny.org/parent-and-family-resources>). I encourage parents and families to use these tools in conjunction with resources and information you receive from your student's teachers.

# Student Attendance

The district recognizes the importance of student attendance and will use a variety of methods to engage students in the learning process. Daily attendance tracking is recorded in the district's student management system, SchoolTool. Calls will be made to the families of students who are absent from school for the day.

## **IMPORTANCE OF REGULAR ATTENDANCE**

Please remember to consult our District calendar when scheduling vacations, medical appointments, etc. We believe that education is important and that children learn best in school. Final examinations will be given on specific dates at specific times. As with NYS Regents Examinations, the Middle School cannot change final exam times. Your cooperation in supporting regular attendance is essential. Our Day A-D calendar indicates the school schedule.

## **STUDENT ABSENCE:**

- **Absence from School:**

When your student is absent from school, **please call** the attendance office prior to 9:00 a.m. On the day your student returns to school, it is necessary to provide the Attendance Office **with a written note or e-mail** explaining the absence (585.247.5053). Written notification about the absence must be received within five school days of the absence or the absence will be marked as "truant."

- **Late Arrival:**

Should your student arrive late to school, call the attendance office with prior notice of the tardiness, or please be sure that the student enters the building with a note explaining the tardiness. Thank you!

- **Early Dismissal:**

If it is necessary for your student to leave school early, a note from home needs to be given to your student to take to the Attendance Office in the morning. For early dismissal, a student must be signed out by a parent/guardian.





# Making up Work/Drop-off/Pick-up Location

## **MAKING UP SCHOOL WORK**

- When a student absence occurs, it is essential that the student assumes the responsibility to catch up on lessons and make up missed assignments. Teachers and counselors will assist students in these efforts. Students who are absent may still find it possible to view the classwork in Schoology and work on completing it.
- In the beginning of the school year, encourage your student to identify a friend in each class to assist when they are absent. Students are encouraged to message teachers through Schoology or e-mail to obtain missed classwork.
- For any student absence of two days or more, you or your student can contact your student's community office to request work. Arrange to pick up the work 24 hours later. Please call the main office before your arrival to ensure that work is available. Pick-up of work is in the Main Office reception area.
- Upon returning from an absence, students should communicate with their teachers to formulate a plan for catching up on missed lessons.

## **STUDENT DROP OFF - PICK UP**

All students are expected to be in their first period class at 7:58 am. If you are dropping a student off at school, please make sure you allow at least ten minutes for the student to unload from the car, enter the building, get breakfast, and walk to first period. Students who are in the building on time, but arrive to first period late, are marked late.

For the safety of our students, the Middle School bus loop will be closed daily from 7:30 a.m. – 8:00 a.m. and 2:30 p.m. – 4:00 p.m. All students being dropped off in the morning for the start of school and/or needing to be picked up at 2:57 p.m. **MUST** be dropped off and picked up at Door 19, which is in our south parking lot (facing Buffalo Road). No other location is acceptable because they are not supervised.

Before school, students being dropped off at Door #19 will not be permitted to enter the building until 7:35 a.m. Students must remain in the car until 7:35 a.m. Staff will be outside to assist with the drop off process to get everyone into the building and out of the parking lot safely. Be advised that due to an anticipated increased number of drop-offs/pick-ups this process will take longer than usual, as we start the school year. We ask for your patience.

Additionally, in the afternoon, to manage the buses and appropriately supervise our students, the only acceptable pick-up location is Door #19. If your student is not taking the bus home and you choose to pick them up, you need to arrive by 2:57 p.m.

Your student's safety is very important to us. Please help us to enforce these expectations by communicating them with your student and dropping off and picking up your student on time and at the appropriate location

## Activity Period/After School

Students stay after school for many reasons. Students are encouraged to participate in extracurricular clubs and intramurals, as well as stay to get extra help from their teachers. These opportunities are offered during the Activity Period from 3:03 p.m. to 3:30 p.m. Students must arrive on time for the Activity Period, or they will risk losing after-school privileges. This includes students who play on sports teams. The after-school time operates like a class period during the school day.

**Students must have prior permission from the supervising teacher to stay after school.** It is the student's responsibility to call home to let parents/guardians know they will be staying after. Students can use school phones to call home. Only students who have received prior permission from a teacher may stay after and receive transportation home. Students who stay after school, but do not have permission to stay after school will be assigned to the detention room until Activity Period ends and a parent/guardian will be contacted to pick up the student.

From time to time, special circumstances or situations can arise for students (for example, confusion about a date for a club meeting). Students can seek assistance from their community or the main office.

### **WALKING HOME:**

**Students may walk/bike ride off campus only if they have obtained a WALKER'S/BIKE RIDER'S PASS from his/her Community Administrator.**

An application for a WALKER'S/BIKE RIDER'S PASS must be signed by a parent or guardian. The signature provides parent/guardian approval that the student may walk or ride a bike directly home. An application can be picked up in the Community Office. It needs to be completed, signed, and returned to the Community Office for administrator approval and processing of a pass for the student. This process may take a couple of days, so it is best to do this with advance notice of when you may need it. A pass may be written for the entire year or for a designated period of time. It is important to specify this on the application. Students who are caught walking or riding a bike home without this pass may be given a consequence.

## Instructional Technology

All students within the district will be provided with a laptop for the school year. Instructional technology guidance and resources to students and parents/guardians are available on the district website at <https://www.gateschili.org>.

# Progress Reports and Report Cards

A critical element of any student's learning experience is the need for timely and meaningful feedback. Three primary purposes for providing student progress reports and report cards are:

1. To communicate student growth to parents and the broader community.
2. To provide feedback to students for self-evaluation.
3. To document student progress and the effectiveness of instructional programs.

Staff provide an indication of student progress towards meeting course expectations and standards every five weeks. There are four quarters in the school year, each being approximately ten weeks. Quarter averages are provided in each course at the end of the ten-week period. These grades go on a child's permanent record. Additionally, we provide progress reports at the five-week point in each quarter. The purpose of progress reports is to provide you and your child with information that gives your child the opportunity to provide additional support, if necessary, in order to meet the expectations and standards for the quarter.

**Report cards and progress reports are posted online through the Parent Portal.** On the Parent Portal you can keep up to date on information such as schedules, quarterly grades, assignment grades, discipline reports, and attendance.

For your reference, the following are the posting dates for progress reports and report cards. These are subject to change. Please keep in mind that both reports will be available for viewing on-line and report cards will be mailed approximately one week after the posting date.

Progress Report Posting Dates	Quarterly Report Card Posting Dates
Friday, October 13, 2023	Friday, November 17, 2023
Friday, December 22, 2023	Friday, February 2, 2024
Friday, March 1, 2024	Friday, April 19, 2024
Friday, May 17, 2024	Wednesday, July 10, 2024

If you have any questions or would like a hard copy of your student's progress report mailed to you, please contact your student's community office.



# Code of Conduct and Character

---

The Gates Chili Central School District Board of Education is committed to providing a safe and orderly school environment where students may receive, and district personnel may deliver, quality educational services without disruption or interference. Responsible behavior by students, teachers, other district personnel, parents, and other visitors is essential to achieving this goal.

The Board recognizes the need to clearly define these expectations for acceptable conduct on school property, to identify the possible consequences of unacceptable conduct, and to ensure that discipline when necessary is administered promptly and fairly. To this end, the Board has adopted a Code of Conduct & Character.

**The District's complete Code of Conduct & Character, is available for review on the district website.**

## **The Spartan Way:**

The continual development of students' character is one of our highest priorities at Gates Chili Middle School. In order to be successful in school and in life, students must not only have the academic skills to meet the demands of the 21<sup>st</sup> century, they must also have the social skills and moral fabric to contribute to the advancement of our society. The values of the Spartan Way outline the behaviors and attitudes which this community embraces as positive ways of life. At Gates Chili Middle School, we teach and model the Spartan Way on a daily basis. Our Code *of Conduct and Character* establishes the standards of behavior for both the students and staff that make up our school community. **Respect, responsibility, compassion, and hard work** comprise our core values.

**Respect ...** *A person of character* values all persons, respects the dignity, privacy, and freedom of others, is courteous, and is accepting of differences.

-----  
**Responsibility ...** A person of character is accountable, pursues excellence, and exercises self-control.

-----  
**Compassion ...** *A person of character* is caring, compassionate, kind, and considerate.

-----  
**Hard Work ...** *A person of character* does their share, helps the community, and is a good school citizen.



# Code of Conduct and Character

## Dress Code:

Students are responsible for wearing appropriate clothing to school. Clothing not allowed includes, *but not limited to*:

- Extremely brief, revealing, or see-through garments.
- Clothing that allows undergarments to be exposed
- Tops with large arm hole openings (exposing torso)
- Items of clothing with sexual, violent, or drug related references or innuendos
- Clothing attachments or accessories that could be considered to be weapons (for example, long chains or spiked jewelry)
- Pants that fall down and are not secured at the waist.
- Slippers
- Shirts without at least a strap
- Shirts exposing skin above the belly button



# Upstander Movement

The Upstander movement is an ongoing and exciting process focused on transforming Gates Chili Middle School (GCMS) from a culture of student bystanders into a community where everyone is aware of the importance of taking a positive stand for all students. The initiative promotes student and staff involvement in school wide programs and activities. Bullying situations have been reduced and the social climate of our school has improved because of students taking action in a positive way to stand up for themselves and others.

Students and adults can work together to make Upstanders an important part of our school. The emphasis on the meaning of being an Upstander is a way to help our Spartan Way values of *Respect, Responsibility, Compassion and Hard Work* become that much more understandable and meaningful daily.

Upstanders are students or student groups that choose to take a positive stand on behalf of themselves and others. They are heroes and are responsible examples to others. Upstanders:

- stand up for their beliefs, while respecting others.
- do what they think is right, even if they stand alone.
- are not simply bystanders; they act to interrupt bully behavior and/or support the target of bullying.
- pay attention if something that is happening is wrong and do something to make things right.
- show compassion toward others.

## DASA: THE DIGNITY FOR ALL STUDENTS ACT

New York State passed the Dignity Act for All Students in 2012.

This act states that:

*"No student shall be subjected to harassment by employees or students on school property or at a school function; nor shall any student be subjected to discrimination based on a person's actual or perceived race, color, weight, national origin, ethnic group, religion, religious practice, disability, sexual orientation, gender (including gender identity or expression), or sex by school employees or students on school property or at a school function."*



Questions regarding DASA can be forwarded to Mrs. Michelle Dossier, Assistant Principal, 585.247.5050





# Gates Chili Middle School Behavior Matrix

## GATES CHILI MIDDLE SCHOOL

 <b>S P A R T A N W A Y</b> 	Classroom	Hallway	Cafeteria	Bathroom	School Bus	Field Trip/ Assembly/Sports
	<ul style="list-style-type: none"> <li>Work cooperatively with teachers and peers</li> <li>Follow classroom expectations</li> <li>Appropriately use materials</li> <li>Respect other's right to learn and participate without ridicule</li> </ul>	<ul style="list-style-type: none"> <li>Walk quietly and safely</li> <li>Be aware of your surroundings</li> <li>Take an active role in keeping your hall clean</li> <li>Respect others' personal space</li> <li>Walk to the right</li> </ul>	<ul style="list-style-type: none"> <li>Speak politely</li> <li>Use good manners</li> <li>Volume control</li> <li>Take pride in your cafeteria</li> <li>Be respectful in lunch line</li> <li>Keep hands to yourself and on your own belongings</li> </ul>	<ul style="list-style-type: none"> <li>Honor people's privacy</li> <li>Keep the environment clean for self and others</li> </ul>	<ul style="list-style-type: none"> <li>Follow adult instructions (bus driver, monitor, staff)</li> <li>Keep the aisle clear and stay in your seat</li> <li>Talk kindly and quietly</li> </ul>	<ul style="list-style-type: none"> <li>Follow adult instructions and event expectations</li> <li>Use appropriate voice for the environment</li> <li>Be positive</li> <li>Respect the location that you are at</li> </ul>
	<ul style="list-style-type: none"> <li>Come prepared to learn</li> <li>Ask for help</li> <li>Take ownership of your actions</li> <li>Complete classwork and homework</li> <li>Arrive on time</li> </ul>	<ul style="list-style-type: none"> <li>Get to class on time</li> <li>Keep locker organized</li> <li>Create a safe environment</li> <li>Report concerns</li> <li>Move quickly but safely</li> <li>Be a model for your peers</li> </ul>	<ul style="list-style-type: none"> <li>Stay in your seat</li> <li>Actively keep your area clean</li> <li>Follow cafeteria expectations</li> <li>Report concerns</li> </ul>	<ul style="list-style-type: none"> <li>Use bathroom appropriately</li> <li>Sign in and out</li> <li>Report concerns and vandalism</li> </ul>	<ul style="list-style-type: none"> <li>Keep track of your belongings</li> <li>Take ownership of your actions</li> <li>Get on your bus promptly and safely</li> <li>Report concerns</li> <li>Take all belongings with you, carry on carry off</li> </ul>	<ul style="list-style-type: none"> <li>Be an active participant</li> <li>Meet the expectations of the experience</li> <li>Positively represent your school and district</li> <li>Follow the social expectations of the setting</li> </ul>
	<ul style="list-style-type: none"> <li>Be an upstander</li> <li>Be tolerant and open minded of others' idea and points of view</li> <li>Show kindness and understanding to all</li> </ul>	<ul style="list-style-type: none"> <li>Be an upstander</li> <li>Be helpful to others</li> <li>Treat others the way you want to be treated</li> <li>Speak kindly to others</li> <li>Speak using an inside voice</li> </ul>	<ul style="list-style-type: none"> <li>Be an upstander</li> <li>Be welcoming and helpful</li> <li>Find positive things to say (no gossip)</li> <li>Appreciate lunch staff (use manners)</li> <li>Welcome new students</li> <li>Invite others to sit with you</li> </ul>	<ul style="list-style-type: none"> <li>Be an upstander</li> <li>Be courteous of others</li> </ul>	<ul style="list-style-type: none"> <li>Be an upstander</li> <li>Allow others to sit with you</li> <li>Be welcoming and helpful</li> <li>Move all the way in so others feel welcomed</li> </ul>	<ul style="list-style-type: none"> <li>Be an upstander</li> <li>Listen with an open mind</li> <li>Learn from and support others</li> <li>Be appreciative</li> </ul>
	<ul style="list-style-type: none"> <li>Be a positive role model</li> <li>Don't give up, be persistent</li> <li>Stay on task</li> <li>Actively participate</li> <li>Try your best</li> </ul>	<ul style="list-style-type: none"> <li>Go directly to your destination</li> <li>Use time wisely</li> <li>Take time to plan out optimal routes with periodic locker stops throughout the day</li> </ul>	<ul style="list-style-type: none"> <li>Lead by example</li> <li>Make your lunch experience positive</li> <li>Use your time wisely, you only have 35 minutes</li> </ul>	<ul style="list-style-type: none"> <li>Go directly to and from the bathroom</li> <li>Use bathroom in a timely manner</li> </ul>	<ul style="list-style-type: none"> <li>Demonstrate appropriate actions and language</li> </ul>	<ul style="list-style-type: none"> <li>Monitor your own behavior</li> <li>Find value in and enjoy the experience</li> <li>Show effort and positive sportsmanship</li> <li>Be an active listener and follow directives</li> </ul>

LIVING THE SPARTAN WAY

# School Safety and Emergency Procedures

## **LOCKED DOORS**

To help ensure safety, all outside doors to the school are locked from the outside after students arrive in the morning. Please acknowledge this policy and do not open a door from the inside to admit anyone. Do not ask a student to let you in through a door. Visitors must use the front doors and immediately report to the office. We use a 2N intercom system at the Middle School. To gain access to the main office, you will need to press the button on the intercom. Someone will talk to you through the intercom to ask how they can help you and then buzz open the door if applicable.

## **PROPER IDENTIFICATION**

**Make sure you have photo identification (ID)!**

If you are picking up a student, the scanning system will allow us to make sure the student is delivered to the correct individual(s). This is one more level of security that ensures our students are safe. If you are picking up your student, after verifying with your ID, we will have you wait in the vestibule while we call your student to the office for dismissal.

## **EMERGENCY PROCEDURES**

To ensure the safety of students and staff, emergency drills are performed throughout the year. During a fire drill, students are evacuated from the building and gather on the school grounds until they are directed to return to the building. We also practice the following situations: Shelter-in-Place, Hold-in-Place, Lock-Out, Lock-Down, and Evacuation to a different location.

In a Shelter-In-Place, students and staff remain in their classroom/offices. Classes continue as normal, but there is no movement in the hallways. A Shelter in Place is typically called for the purpose of weather emergencies.

In a Hold-In-Place, students and staff remain in their classroom/offices. Classes continue as normal, but there is no movement in the hallways. A Hold in Place is typically called for the purpose of medical emergencies.

In a Lock Out, the school continues to operate under normal daily routines within the building but curtails outside activity and visitors.

In a Lock Down, students remain in one location with doors and windows locked and student movement within the building ceased immediately.

In an Evacuation to a different location, students and staff leave the building and go to a safe location.

## **EMERGENCY SCHOOL CLOSINGS**

In the event of inclement weather or an emergency school closing, information will be immediately posted on our district website at [www.gateschili.org](http://www.gateschili.org). School closing information will be broadcast on our local radio and television stations. School closings should be announced by 6:00 a.m. In the event of an early dismissal, announcements will also be made on those stations. During an emergency, please do not call the school about closings unless it is absolutely critical. This ties up the phone lines and hampers communication for emergency services.



# School Safety and Emergency Procedures

Since emergency situations cannot be predicted, it is essential to establish alternative plans. This is especially true during the pandemic when schools may be shut down with little notice. In helping you prepare alternative arrangements for your child's supervision and safety; the following steps are offered:

- Make arrangements with a neighbor or relative to take care of your student if you will not be home.
- Discuss and practice these procedures with your student to ensure they know where to go if an emergency school closing is required.



# Support Services (Health Office and Counseling)

## **HEALTH OFFICE**

- All seventh-grade students and every student new to the district will need to have a physical examination. This can be performed by the family physician or the school physician. Scoliosis screening for all students will be done in the nurse's office. Vision and hearing screening for all students new to the district and for all grade 7 students will take place. Parents will be notified of any test results which appear to need a follow-up.
- Any accident or injury occurring on school property must be reported to the health office by the injured person.
- If your child is seriously ill, or injured, or will be out more than three (3) days, the nurse should be contacted at 585.247.6780.
- **Immunizations**—All students need to be compliant with New York State immunization requirements in order to attend school.
- **Dispensing Medication**—State law requires the following if a student must take medication (prescription and/or over the counter) during school hours; There must be:
  - a written request from the doctor.
  - a written request from the parent/guardian.
  - medication in a labeled prescription bottle.
  - medication delivered to the health office by an adult. Unused medication should be picked up by an adult the last week of school. Medications not picked up will be discarded.

## **COUNSELING SERVICES**

- The Middle School offers individual and group counseling to students.
- General counseling lessons are conducted in classroom settings. Topics may include tools for academic success, peer relationships, and self-esteem.
- Counselors plan with individual students to facilitate a smooth transition to the next grade level.
- Parents may contact counselors at 585.247.5050. See counselor assignments listed below:

### **SCHOOL COUNSELORS**

- Grade 6 Amerks & Redwings: Ms. Nelson
- Grade 7 and 8 Amerks: Mrs. Rice
- Grade 7 and 8 Redwings: Ms. Sabido
- Grade 6 - 8 Rhinos: Mrs. Condidorio

## **PSYCHOLOGICAL SERVICES**

The Middle School offers psycho-educational assessments for students with special needs. School psychologists are also available to consult on matters of academic assistance and personal adjustment.

### **SCHOOL PSYCHOLOGISTS (585.247.5050):**

Mrs. Carroll, Mrs. Salton, and Mrs. Yates

### **SCHOOL SOCIAL WORKER: Ms. Gorski; Mrs. Sprague; Mrs. McKenzie**

The Middle School offers services to help facilitate communication among school and home and community agencies.

# School Nutrition Program

## **SCHOOL NUTRITION PROGRAM**

The Gates Chili Central School District believes one of the most important ways we can help our children perform better in their classrooms is to provide them with the nutrition necessary for the healthy growth of their minds and bodies. Gates Chili participates in the National School Lunch Program and School Breakfast Program.

**Meal Prices:** For the 2023-2024 School year meal prices are:

- Breakfast: \$2.10
- Lunch: \$3.30
- Milk: \$.60

### **Free & Reduced Meals**

Families who may be eligible can apply for free or reduced priced meals; ***applications are available on the GC website.***

### **Menus**

For menus, please access the breakfast and lunch menus by going to [gateschili.org/menus](https://gateschili.org/menus) or through the district's mobile app.

### **Meal Purchasing**

Gates Chili uses MySchoolBucks for school meals and other payments. Families can add funds for school meals to their student's accounts.

Families are offered the convenience of prepaying for School Meal purchases; a check may be given to the School Nutrition Manager at the Middle School or mailed to Gates Chili School Nutrition Services, 2 Spartan Way, Rochester, NY 14624 (Make Checks payable to Gates Chili School Nutrition.)

If paying with cash at the cash register, please note we do not give back change. Any change from a purchase will go onto the student's meal account.

- In an emergency if you forget your lunch or lunch money, you will be given a regular breakfast or lunch. You will need to remit the cost of the meal to the School Nutrition Office the following day.
- **FREE and REDUCED Priced Meal Applications:**  
The updated new Applications will be available on-line. Additional copies will be provided in each building's main office to have available. The link to the on-line application can be found on the School Nutrition portion of the District Web Page. (<https://www.gateschili.org/domain/27>)

You may contact the School Nutrition Office at 585.247.5050 or e-mail at:

[Janice\\_Phillips@gateschili.org](mailto:Janice_Phillips@gateschili.org)

# PTO/Volunteer Opportunities

## Parent Teacher Organization (PTO)

Learn more about your child's education by becoming a part of the PTO. The PTO is actively involved in helping to partner parents, teachers, and the community. They sponsor workshops throughout the school year for parents/guardians, facilitate fundraising, support teacher proposals for funding, and are involved in social events.

Middle School PTO Meetings will be held at 7:00 pm in the library. The dates for the 2023-2024 meetings are:

Date
9/19/2023
10/17/2023
11/14/2023
No Meeting in December
1/16/2024
2/6/2024
3/19/2024
4/23/2024
5/14/2024
No Meeting in June

## Middle School PTO Officers

President - Meagan Todd

Vice President - Mary Housel-Demanchick

Secretary - Tanya Srbinovski

Treasurer - Ryan Kozak-Weaver

Fundraising Coordinator - Sarah Kozak-Weaver

## Contact Information

- PTO e-mail address is [gcmspto@gmail.com](mailto:gcmspto@gmail.com)

## PTO Fundraising

The profit from the fundraiser(s) are used to supplement school activities—AND—students who participate in the fundraising will earn funds towards their grade 8 class trip! Fundraising information will be shared with students and families as it becomes available.

## Volunteer Opportunities

Many programs/activities need parent assistance. **Volunteers enhance school programs.**

Volunteering is a great way for you to become more involved in your child's education. PTO is always seeking volunteers. If you are interested in volunteering in the Middle School, please e-mail [marla\\_chefalo@gateschili.org](mailto:marla_chefalo@gateschili.org). You will need to complete some paperwork and obtain Board of Education approval and support for your service.



# Extracurricular/Enrichment Opportunities

## ACADEMIC COMPETITION

### Academic Challenge Bowl

Come challenge yourself with great trivia questions. Flex those brain muscles with friends and meet someone new. Our 7th and 8th graders have the opportunity to represent GCMS and participate in competitive trivia contests against other schools.

**Advisor:** Ms. Boswell

**Email:** [jazmine\\_boswell@gateschili.org](mailto:jazmine_boswell@gateschili.org)

### Chess Club

Club members learn to play chess and improve individual skills in a fun and friendly way. All skill levels are welcome and meetings are scheduled two times per month.

**Advisor:** Alex LeClair

**Email:** [alleclair@gateschili.org](mailto:alleclair@gateschili.org)

### Math Counts

Seventh and eighth grade students meet once a month to prepare for the Monroe County Math Counts Competition. Four team members and four alternates have been chosen to represent our school.

**Advisor:** TBD

**Email:**

## ATHLETICS

Students in 7<sup>th</sup> and 8<sup>th</sup> grade can try out for participation in Modified and/or JV Sports. Information regarding our robust athletic program is available on the district website at [www.gateschili.org](http://www.gateschili.org).

### Intramurals

The Intramural program evolves from activities in the instructional program. It provides an opportunity to apply the skills learned in physical education class. It is open to any student who wants to participate. The emphasis is on participation, low-key competition and FUN!

**Advisor:** Mr. Candileri

**Email:** [michael\\_candileri@gateschili.org](mailto:michael_candileri@gateschili.org)

### Ski Club

All 6th, 7th, and 8th graders may participate in ski club. We will ski or snowboard on six Wednesdays in January and February. Students can learn how to ski or snowboard from certified skiing instructors. Ski Club information with this year's prices will be available in September.

**Advisor:** Mrs. Radley and Mrs. Carr

**Email:** [kathryn\\_radley@gateschili.org](mailto:kathryn_radley@gateschili.org)  
[susan\\_carr@gateschili.org](mailto:susan_carr@gateschili.org)

### Synchronized Swim Club

Students learn synchronized swimming and learn routines to music which are incorporated into a production. The swimmers will perform in costumes and under spotlights for the community.

**Advisors:** Mrs. Mantisi

**Email:** [tinamarie\\_mantisi@gateschili.org](mailto:tinamarie_mantisi@gateschili.org)

## FINE ARTS Art/Music/Drama

### Art Club

Art Club offers creative projects and experiences to students who are interested in the visual arts.

**Advisors:** TBD

**Email:** [alyssa\\_viggiani@gateschili.org](mailto:alyssa_viggiani@gateschili.org)

### Culinary Club

In this club students will familiarize themselves in the kitchen by creating new recipes each month.

**Advisors:** Mrs. Blaesi and Mrs. Navarro-Lindsay

**Email:** [stephanie\\_blaesi@gateschili.org](mailto:stephanie_blaesi@gateschili.org)  
[dana\\_navarro-lindsay@gateschili.org](mailto:dana_navarro-lindsay@gateschili.org)

### Dramatics Club

Do you like to entertain or make people laugh? Come to Drama Club! We will play theater games, read scenes from movies, musicals, and TV shows, as well as learn how to speak, move, and act in ways that will entertain any audience. We will also help promote the Spartan Way and Upstander Movement.

**Advisor:** Ms. DeGrave

**Email:** [rjdegrave@gateschili.org](mailto:rjdegrave@gateschili.org)

### Jazz Band

The GCMS Jazz Ensemble is open to students grades 6-8 through teacher selection. Instrumentation includes trumpet, saxophone, trombone, drum set, piano, xylophone, bass, and voice. Performances include local festivals, social functions, and formal concerts.

**Advisor:** Mr. Carbary

**Email:** [michael\\_carbary@gateschili.org](mailto:michael_carbary@gateschili.org)

### Musical

A musical is held each year in November. Try-outs are held for participation in this group.

**Advisors:** Mrs. Bala, Mrs. Volpe

**Email:** [jessica\\_volpe@gateschili.org](mailto:jessica_volpe@gateschili.org)

### Spartan Original Singers: Vocal Ensemble

The Middle School Vocal Ensemble is known as S.O.S. (Spartan Original Singers). This group combines singing and choreography and represents GCMS at various events in the school district and community. Auditions are held in June for students entering the 7th and 8th grade.

**Advisor:** Mrs. Ciarvella and Mrs. Volpe

**Email:** [julie\\_ciarvella@gateschili.org](mailto:julie_ciarvella@gateschili.org)

### Talent Show

The Talent Show is a great opportunity to share your unique talents with your friends and family. All students are welcome to try out to participate in our annual talent show. Singers, dancers, comedians, artists, magicians or musicians can perform solo or with a group. Participants should be prepared to work hard, be responsible and most of all, HAVE FUN!

**Advisor:** Mrs. Martinek and Ms. Davenport

**Email:** [janet\\_martinek@gateschili.org](mailto:janet_martinek@gateschili.org)  
[dkdavenport@gateschili.org](mailto:dkdavenport@gateschili.org)

# Extracurricular/Enrichment Opportunities

## LITERARY COMMUNICATION

### Bookstore

Bookstore helpers who display hard work and responsibility are selected through recommendations by teachers and an application process. During the school day, helpers are directly involved in the operation of our school store. There are two meetings during the school year that bookstore workers must attend in order to work in the store.

**Advisor:** Mrs. Falletti

**Email:** [maddalena\\_falletti@gateschili.org](mailto:maddalena_falletti@gateschili.org)

### Newspaper Club

GCMS students gather information from staff and students to produce a student-run newspaper. Students will work cooperatively with other students to be a reporter, interviewer, editor and distributor. Get to know other students and teachers and exemplify the Spartan Way by reporting on all the happenings at the middle school.

Occasionally the club meets to play games and have fun

**Advisors:** Ms. DeGrave

**Email:** [rjdegrove@gateschili.org](mailto:rjdegrove@gateschili.org)

### Yearbook Club

Students, under the direction of their advisor, work throughout the year to develop the annual yearbook.

**Advisor:** Mrs. DeGrave

**Email:** [rebecca\\_degrove@gateschili.org](mailto:rebecca_degrove@gateschili.org)

## SERVICE/LEADERSHIP

### Agape Club

“Faith, Friends, Fun on Fridays!” Agape Club promotes a safe environment (verbally and physically) where kids can have fun, play games, and socialize, all while discussing everyday issues with a Christian foundation.

**Advisor:** Mrs. Mantisi

**Email:** [tinamarie\\_mantisi@gateschili.org](mailto:tinamarie_mantisi@gateschili.org)

### Leo Club

Leo Club is a cooperative venture with the Gates and Chili Lions Clubs to provide positive volunteer experiences for Middle School students. Club meets every other Wednesday.

**Advisor:** Mrs. Blaesi and Mrs. Navarro-Lindsay

**Email:** [stephanie\\_blaesi@gateschili.org](mailto:stephanie_blaesi@gateschili.org)

[dana\\_navarro-lindsay@gateschili.org](mailto:dana_navarro-lindsay@gateschili.org)

### Make a Difference Club

Team members work with the advisors, school and community groups doing service projects that “Make A Difference.”

**Advisor:** Ms. Fox

**Email:** [jessica\\_fox@gateschili.org](mailto:jessica_fox@gateschili.org)

### Multicultural Club

Multicultural Club offers students the opportunity to experience cultural diversity through a variety of after school activities. The club time will include learning some common phrases, food, guest speakers, games and videos that highlight people and places around the world.

**Advisor:** TBD

**Email:** [jazmine\\_boswell@gateschili.org](mailto:jazmine_boswell@gateschili.org)

### National Junior Honor Society

NJHS honors those students who have demonstrated excellence in the areas of scholarship, leadership, service, citizenship and character. Students are selected for NJHS and will meet throughout the year.

**Advisor:** Mr. Chase

**Email:** [james\\_chase@gateschili.org](mailto:james_chase@gateschili.org)

### Peer Ambassadors

Members of this group work throughout the year supporting students and parents. Ambassadors regularly assist in functions such as “Meet the Staff Night” and “Family Fun Night.” They also participate in acts of good will helping teachers and principals. This program is available to 7th and 8th grade students only and by recommendation only. Recommendations are made in the spring of each year for the following academic year.

**Advisors:** Mrs. Paiment and Mrs. Strong

**Email:** [charlene\\_paiment@gateschili.org](mailto:charlene_paiment@gateschili.org)

[theresa\\_strong@gateschili.org](mailto:theresa_strong@gateschili.org)

### Peers Against Substance Abuse (PASA)

Students who join this group are interested in promoting positive lifestyle choices by making a commitment to live drug free. Students learn how to discourage their peers from using alcohol, tobacco and other drugs. Members of this club play games, watch movies/presentations, listen to music, participate in outdoor activities, and have fun together while participating in healthy/safe alternatives to drug use. Students will help plan Red Ribbon Week and participate in other fun, drug-free activities throughout the year.

**Advisors:** Mrs. Henchen and Mrs. Strong

**Email:** [jill\\_henchen@gateschili.org](mailto:jill_henchen@gateschili.org)

[theresa\\_strong@gateschili.org](mailto:theresa_strong@gateschili.org)

### Relay for Life

The Relay for Life Club meets monthly to determine, plan and participate in school-wide Relay for Life events throughout the school year. This club then promotes and inspires other students to join the Relay for Life Middle School Team that takes place at the GCHS in June. If you have a passion for cancer awareness as well as planning school wide events, this is for you!

**Advisor:** TBD

**Email:**

### School Improvement Team (SIT)

SIT is a Middle School group comprised of teachers, support staff, principals, students and parents who meet regularly to create and implement programs and ideas to improve student achievement. The meetings will occur once a month. On alternating months, the SIT meeting will occur at 3:05 pm and then the next month 6 pm. This is designed to make it more convenient for parents/guardians to become involved, as well as students.

**Advisor:** Dr. Buckshaw

**Email:** [lisa\\_buckshaw@gateschili.org](mailto:lisa_buckshaw@gateschili.org)

# Extracurricular/Enrichment Opportunities

## Student Council

Student Council officers and representatives are elected by the student body. They meet regularly to plan school-wide activities, help increase school spirit, and sponsor fund raising events.

**Advisors:** Mrs. Dorofy and Mrs. Salgado-Givens

**Email:** [lisa\\_dorofy@gateschili.org](mailto:lisa_dorofy@gateschili.org); [frances\\_salgado-givens@gateschili.org](mailto:frances_salgado-givens@gateschili.org)

## Upstander Club

Upstander Club is an opportunity for students who recognize the power behind standing up for what is right in school and recognize they can influence others to do the same. This is a student-led club where the activities and opportunities will be student generated, designed, and delivered in powerful and creative ways through the school.

**Advisor:** Ms. Sabido

**Email:** [kereen\\_sabido@gateschili.org](mailto:kereen_sabido@gateschili.org)

## SOCIAL SCIENCE

### Gay Straight Alliance (GSA) Middle School Club

The GSA promotes awareness, respect, compassion, and inclusion of all. This club is an opportunity for students to discuss issues, plan activities related to diversity, and provide support. The overall goal of the GSA is to create a welcoming environment for all students and ensure a sense of belonging in their Middle School.

**Advisor:** Ms. Sabido

**Email:** [kereen\\_sabido@gateschili.org](mailto:kereen_sabido@gateschili.org)



## STEM

### Science/Technology/Engineering/Math

#### Lego Club

6<sup>th</sup>, 7<sup>th</sup> and 8<sup>th</sup> students will prepare to compete in the FLL Robotics Competition. Each year, FLL introduces a scientific and real-world challenge for teams to focus on and research.

**Advisor:** Mrs. Radley and Mrs. Carr

**Email:** [kathryn\\_radley@gateschili.org](mailto:kathryn_radley@gateschili.org)  
[susan\\_carr@gateschili.org](mailto:susan_carr@gateschili.org)

#### Science Club

Come have fun while you increase your science knowledge. Science Club is open to all students. Some past activities include: building earthquake towers, holiday specific science experiments, and other

**Advisor:** Dr. Williamson

**Email:** [robin\\_williamson@gateschili.org](mailto:robin_williamson@gateschili.org)

#### Technology Club

Students will engage in design challenges relative to simple machines, electromagnetism, motors, and circuitry. Come have fun while you increase your science knowledge.

**Advisor:** TBD

**Email:**



# STEP - MCC Program

## **Purpose:**

Gates Chili Middle School collaborates with Monroe Community College (MCC) to encourage and support students with interest in pursuing a career in science, technology, math, and licensed professions. We offer a Science Technology Entry Program (STEP), which is an academic enrichment program. STEP is funded through a grant by New York State Education Department. The intent of the grant is to increase the number of historically underrepresented and economically disadvantaged students prepared to enter college and to improve their participation rate in these fields of study. Admission into this program is competitive and requires students to participate in an application process.

## **Eligibility:**

The eligibility requirements are:

- minimum overall average of 78%
- enrolled in grades 7 or 8

Students who are not underrepresented (e.g. Black/African American, Hispanic/Latino, Alaskan Native, or American Indian) must meet economically disadvantaged eligibility guidelines as established by NYS.

## **Target Audience:**

- Economically disadvantages; or
- Black/African American, Hispanic/Latino, Alaskan Native, or American Indian

## **Program Services:**

- Core subject support
- Internships
- 3-week Summer Bridge Program that is free to STEP students.
- Field trips in the fields of math, science, technology and licensed professions
- Academic competitions
- Standardized tests preparation
- Career awareness/development activities
- HS and College admission counseling

Nicole Fedele is the MCC-STEP Advisor for our Middle School. She may be contacted by e-mail at [Nicole\\_fedele@gateschili.org](mailto:Nicole_fedele@gateschili.org)





# Non-Discrimination Policy

## Notice of Non-Discrimination

The Gates Chili Central School District does not discriminate on the basis of an individual's actual or perceived race, color, religion, creed, ethnicity, national origin, citizenship status, age, marital status, partnership status, disability, predisposing genetic characteristics, sexual orientation, gender (sex), military status, veteran status, domestic violence victim status or political affiliation, and additionally does not discriminate against students on the basis of weight, gender identity, gender expression, and religious practices or any other basis prohibited by New York State and/or federal non-discrimination laws in employment or its programs and activities. The District provides equal access to community and youth organizations. Inquiries regarding the District's non-discrimination policies should be directed to:

### **Title IX Civil Rights Compliance Officer:**

Assistant Superintendent for Human Resources and Labor Relations (Primary)

Associate Superintendent for Instruction (Secondary)

### **Section 504 Coordinator:**

Director of Pupil Services

Gates Chili Central School District

3 Spartan Way

Rochester, New York 14624

585.247.5050

[civilrightscompliance@gateschili.org](mailto:civilrightscompliance@gateschili.org)





# Middle School Map

## Gates Chili Middle School

2 Spartan Way  
GCSD

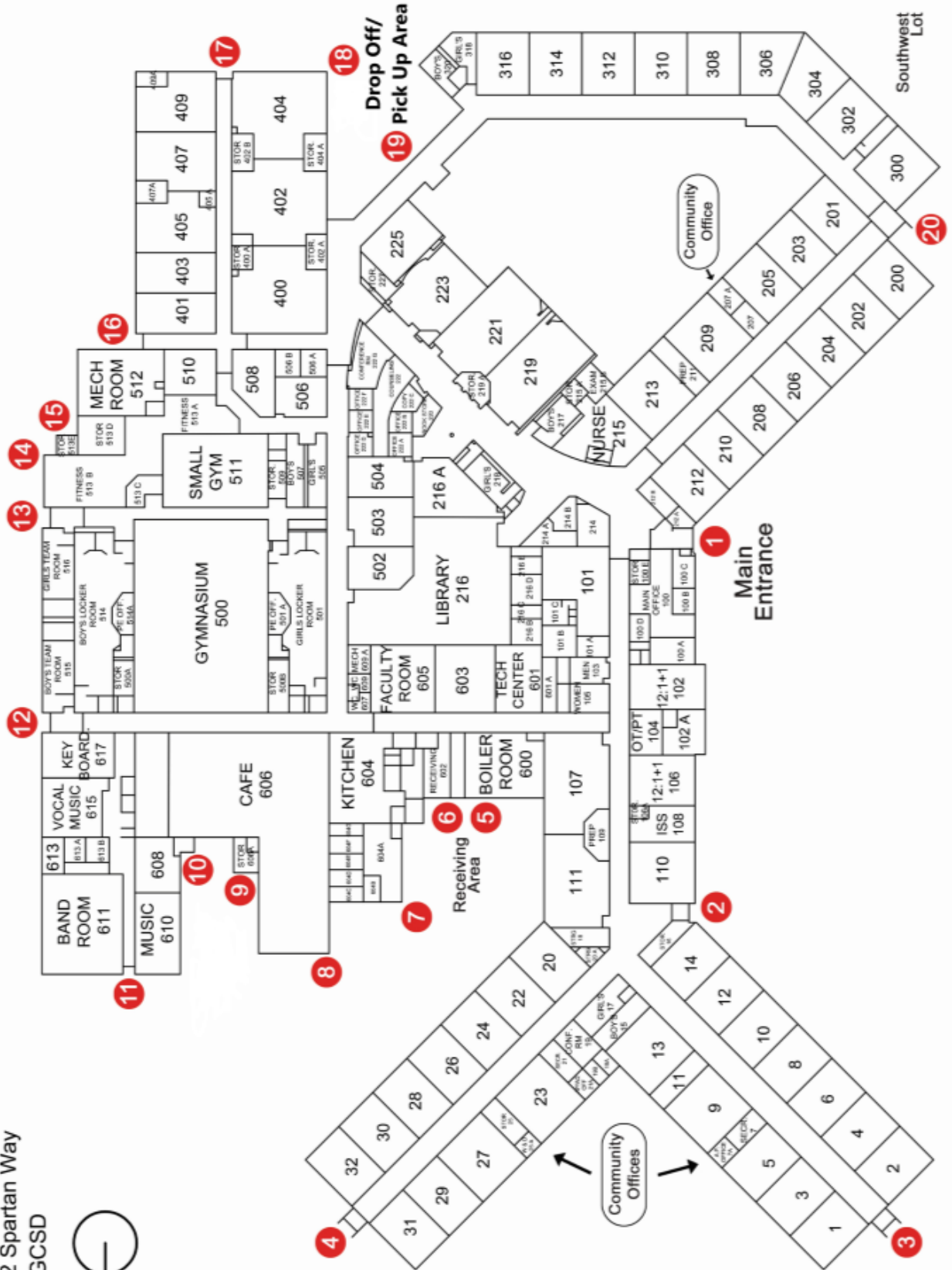

# Board of Education 2022- 2023

---



## *Gates Chili Central School District Board of Education Members*

Ms. Catherine Coffee

***President***

Mr. Francis Muscato

***Vice President***

Mr. Michael Bailey

Mrs. Katie Davis

Mrs. Kerri Keyes

Mrs. Nicole Littlewood

Mr. Robert Long

Dr. Christine Brown Richards

*Superintendent of Schools*

Mr. Christopher Dailey

*Assistant Superintendent for Curriculum and Instruction*

Mr. Troy Olin

*Assistant Superintendent for Business*

Dr. Michell Ball

*Assistant Superintendent for Human Resources and Labor Relations*

Michaela Perrotto, Esq.

*Assistant Superintendent for Student Support Services*

Mr. Jason deJong

*Director of Communications*

Iva Petrosino

*Director of Technology*

Mr. Jeff McKinney

*Director of PE, Health and Athletics*

Mr. Ken Hammel